



I



营销热线 Marketing Hotline

- ☎ : +86 25 84677638
- 📱 : +86 153 5818 2650
- 📠 : +86 25 8679 2901
- ✉ : jackynie@wincoo.com.cn
- 👤 : whatsapp:+86 153 5818 2650
- 💬 : wechat:+86 189 1594 2901

Website:
<http://wincoomachine.en.made-in-china.com;>
<https://njwincoo.en.alibaba.com/>
www.wincoo.com.cn

Blasting and Painting machines

Product Contents

产品索引

表面清理及铸机系列

SURFACE CLEANING & FOUNDRY MACHINERY



Q69系列钢板型材抛丸清理机
Q69 Series Steel Profiles Shot Blasting Machine

1



QG系列钢管内外壁抛丸清理机
QG Series Inner And Outer Wall Special Shot Blasting Machine

3



Q38、Q48、Q58系列悬挂、积放链式抛丸清理机
Q38, Q48, Q58 Series Hanging Chain & Piled And Released Chain Type Shot Blasting Machine

5



QWD网带式抛丸清理机
QWD Mesh Belt Shot Blasting Machine

7



Q37系列吊钩式抛丸清理机
Q37 Series Hook Type Shot Blasting Machine

9



Q32系列履带式抛丸清理机
Q32 Series Tumble Belt Shot Blasting Machine

11



QT37系列环轨通过式抛丸清理机
QT37 Series Circular Track Through Type Shot Blasting Machine

13



15/28 GN钢履带式抛丸机
15/28 GN Steel Crawler Shot Blasting Machine

15



转台式强化、抛丸清理机
Turntable Type Strengthening Shot Blasting Machine

17



台车式抛丸清理机
Trolley Type Shot Blasting Machine

19



全自动回收喷砂房
Automatic Recycling Sand Blasting Room

21



喷漆房
Painting Room

23



移动式路面抛丸清理机
Mobile Type Road Surface Shot Blasting Machine

25



抛丸器
Shot Blasting Turbine

27



脉冲带式除尘设备
Pulse Bag Dust Equipment

29



滤筒式除尘设备
The Filter Cartridge Dust Removal Equipment

31



消失模铸造生产线
EPC Production Line

33



V法铸造生产线
V-Process Casting Production Line

34

Product Contents

产品索引

数控锻压及自动化系列

CNC FORGING & AUTOMATION



闭式液压数控转塔冲床AMD—357
Closed Type Hydraulic CNC Turret Punch Machine AMD—357

35



闭式机械数控转塔冲床AMD—357
Closed Type Mechanical CNC Turret Punch Machine AMD—357

37



伺服式数控转塔冲床
Servo Type CNC Turret Punching Machine

39



开式机械数控转塔冲床AMD—2510
Open Type Mechanical CNC Turret Punch Machine AMD—2510

41



开式机械数控转塔冲床AMD—255
Open Type CNC Turret Punch Machine AMD—255

43



开式液压数控转塔冲床AMD—3510
Open Type Hydraulic CNC Turret Punch Machine AMD—3510

45



重荷载特钢数控冲压设备
Hydraulic Thick Plate CNC Turret Punching Machine

47



汽车大梁数控冲孔生产线
Car Girder CNC Punching Production line

49



简易型数控冲床AMD—PQ
Simple Type CNC Turret Punch Machine AMD—PQ

51



平台型数控冲床AMD—P
Platform CNC Turret Punch Machine AMD—P

53



剪板机前数控送料AMD—JB
CNC Steel Plate Shearer Front Feeding AMD—JB

55



数控剪板机AMD—SKJ
CNC Shearing Machine AMD—SKJ

57



数控折弯机AMD—SKZ
CNC Press Brake AMD—SKZ

59



型材生产线
Profile Production Line

61



表面清理及铸机系列

SURFACE CLEANING & FOUNDRY MACHINERY

专注于为用户打造
最具性价比的产品价值与服务.....

Focus on the best service and most cost performance product value...

WINCOO ENGINEERING CO.,LTD

Q69系列钢板型材抛丸清理机

Q69 Series Steel Profiles Shot Blasting Machine



产品特点

该系列钢板、型材抛丸预处理线主要由辊道输送机构、抛丸处理、弹丸清扫工序组成。适用于船舶、汽车、机车车辆、桥梁、机械等行业的钢板、型材及结构件的表面除锈、涂漆工艺。

应用示例 Application Case

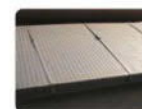

◇ 技术参数 Technical Parameters

型号 TYPE	Q698	Q6912	Q6915	Q6920	Q6925	Q6930	Q6940
有效清理宽度 (mm) The effective cleaning width	800	1200	1500	2000	2500	3000	4000
室体进口尺寸 (mm) The room feed-in size	1000 × 400	1400 × 400	1700 × 400	2200 × 400	2700 × 800	3200 × 800	4200 × 400
清理工件长度 (mm) The length of cleaning workpiece	1200~12000	1200~1600	1200~12000	1200~12000	3000~12000	2400~12000	4500~18000
辊道输送速度 (无级调速) (m/min) The speed of wheel conveyor (stepless speed variation)	0.5~4	0.5~4	0.5~4	0.5~4	0.5~4	0.5~4	0.5~4
清理钢板厚度 (mm) The thickness of cleaning steel sheet	3~60	3~60	1.5~60	3~60	3~60	3~110	4.5~100
处理型材规格 (mm) The section steel specification	800 × 300	1000 × 300	1500 × 300	2000 × 300	2500 × 700	3000 × 700	4000 × 300
抛丸量 (kg/min) The quantity of shot blasting	4 × 180	4 × 250	4 × 250	6 × 250	6 × 250	6 × 360	8 × 360
首次装入量 (kg) The first enclosed quantity	4000	4000	4000	4500	4500	8000	11000
滚刷 (刮板) 调整高度 (mm) Roll brush adjusting height	200	200	350	450	600	850	900
通风量 (m³/h) Airless capacity	22000	17560	19000	19550	27758	28550	38000
外形尺寸 (mm) Exterior size	25017 × 4500 × 3015	12180 × 4250 × 7095	15200 × 5370 × 6797	20650 × 6850 × 9095	31200 × 8070 × 7500	44042 × 6385 × 7758	45000 × 7830 × 11117
总功率 (不含除尘) (kw) Total power (except for dust cleaning)	90	78.3	113.5	156.6	204.8	224.55	293.6

可根据用户钢材的尺寸及生产节拍等参数，设计制作各种非标准钢材预处理设备。
We can design and manufacture all kinds of non-standard shot blasting machines according to customer different workpiece detail requirement, weight and productivity.

Product Features

The series of Q69 steel plate & Profiles shot blasting pre-treatment line is mainly consist of roller conveying mechanism, blasting processing, abrasive cleaning procedure, etc. It applies to surface rusting and painting art of shipping, car, motorcycle, bridge, machinery, etc.

QG系列钢管内外壁抛丸清理机

QG Series Inner And Outer Wall Special Shot Blasting Machine



产品特点

该系列钢管内外壁专用抛丸处理机适用于钢管及钢管类产品的表面处理，去除其表面氧化皮、焊渣等杂物，呈现出金属光泽，增加其表皮面积，以利于工件表面的喷涂及涂敷。广泛应用于石油化工、钢铁、城市集中供热、供排水等行业。



◇ 技术参数 Technical Parameters

参数 Parameter 型号 Type	清理尺寸 (mm) Cleaning size	清理速度 (m/min) Cleaning speed	用途 Purposes
QGW100	Φ50-300	2-10	外壁抛丸清理 Outer wall of shot blasting machine
QGW720	Φ159-720	2-6	
QGW1200	Φ219-1016	1-6	
QGW1500	Φ325-1600	1-6	
QGW2800	Φ1016-2800	1-2	
QGN100	Φ50-300	1-4	内壁抛（喷）丸清理机 Inner wall of shot blasting machine
QGN700	Φ325-720	1-2	
QGN1000	Φ720-1016	1-4	
QGN1500	Φ1016-1500	1-4	

可根据用户钢管的尺寸及生产节拍等参数，设计制作各种非标准钢管内外壁抛、喷丸设备。
We can design and manufacture all kinds of non-standard shot blasting machines according to customer different workpiece detail requirement, weight and productivity.

Product Features

The series of QG inner and outer wall special shot blasting machine for surface treatment, wiping up the oxide coating, welding slag, appearing the metallic sheen, increasing the area of the surface, which is in favor of UV. It applies in the line of petroleum & chemical, steel, city centralized heating, centralized drainage etc.

Q38、Q48、Q58系列悬链、积放链式抛丸清理机

Q38, Q48, Q58 Series Hanging Chain & Piled And Released Chain Type Shot Blasting Machine



产品特点

该系列产品采用多工位定点旋转抛射清理的方式将铸件表面的粘砂、氧化皮去除，使铸件重现金属本色。主要用于汽车配件及机车的摇枕、侧架、车钩及钩尾框等车辆件，同时也可清理近形尺寸的铸件和批量小件。

应用示例 Application Case



◇ 技术参数 Technical Parameters

参数 Parameter	Q383/Q483	Q385/Q485	Q4810
型号 Type			
清理工件尺寸 (mm) Cleaning workpieces size	Φ800 x 1200	Φ1000 x 1500	Φ1000 x 2500
工位数 Number of work position	2	2	2
抛丸器数量 Quantity of impeller head	4	4	6
抛丸量 (kg/min) Impeller head volume	4 x 250	4 x 250	6 x 250
抛丸器功率 (kw) Impeller head power	4 x 15	4 x 15	6 x 15
吊钩最大重量 (kg) Max hanging weight	300	500	1000
生产率 (h) Productivity hanger	30-60	30-60	40-60
清理室尺寸 (mm) Size of the cleaning room	7680 x 2000 x 2900	7680 x 2000 x 2900	7680 x 2000 x 3800
总送风量 (m³/h) Total air rate volume	17000	19000	19000
总功率 (不含除尘) (kw) Total power (except for dust cleaning)	73.15	73.15	114.72

可根据用户的生产实际要求，设计制作各种非标准悬链及积放链-步进及连续通过式抛丸机。
We can design and manufacture all kinds of non-standard shot blasting machines according to customer different workpiece detail requirement, weight and productivity.

Product Features

This series machine uses the method of multistep fixed-point rotation blasting and cleaning, removing the sand and oxide skin on the casting surface, to reappear metal color. It is mainly used in car accessories and bolster, side frame, coupling, and frame of trail hook vehicle parts, at the same time also can clean the casting and small batch workpiece with similar size.

QWD网带式抛丸清理机

QWD Mesh Belt Shot Blasting Machine



产品特点

QWD系列网带式抛丸机主要用于薄壁铸件、薄壁和脆弱的铁或铝合金铸件、陶瓷等小型零件的表面抛丸清理，亦可用于机械零件抛丸强化。QWD系列网带式抛丸机具有连续性好、清理效率高、变形小、无地坑等特点，既可单独使用，又可配线使用。

应用示例 Application Case



◇ 可根据用户的生产实际要求，设计制作各种非标准网带连续通过式抛丸机及生产线。
We can design and manufacture all kinds of non-standard shot blasting machines according to customer different workpiece detail requirement, weight and productivity.

Product Features

QWD series mesh belt shot blasting machine is mainly used for surface cleaning of thin-wall castings, thin-wall and fragile iron or aluminum alloy castings, ceramic, etc small parts, it can also be used for mechanical parts blasting and intensifying. QWD series mesh belt shot blasting machine has advantages of good continuity, high cleaning efficiency, small deformation, no pit, etc., it can be used alone, also can be used in a production line.

Q37系列吊钩式抛丸清理机

Q37 Series Hook Type Shot Blasting Machine



产品特点

该系列为吊钩式抛丸清理机，主要用于铸件、结构件、有色合金件及其它零件的表面清理，本系列抛丸清理机分单钩、双钩式，起吊、不起吊式等多种型号。它具有无地坑、结构紧凑、生产率高等优点。

应用示例 Application Case



◇ 技术参数 Technical Parameters

参数 Parameter	类型 Model	清理工件尺寸 直径 × 高度 (mm ²) Cleaning workpieces size : diameter × height	单钩载重量 (kg) The carrying capacity of unit hook
型号 Type			
Q375	单钩 Single-hanger	500 × 1000	500
Q376	单钩 Single-hanger	800 × 1200	600
Q376E	双钩 Double-hanger	800 × 1200	600
Q378	单钩 Single-hanger	1000 × 1500	800
Q378E	双钩 Double-hanger	1000 × 1500	800
Q3710	单钩 Single-hanger	1200 × 1600	1000
Q3710E	双钩 Double-hanger	1200 × 1600	1000
Q3720	单钩 Single-hanger	1500 × 2000	2000
Q3730	单钩 Single-hanger	1500 × 2000	3000
Q3750	单钩 Single-hanger	2000 × 2500	5000

可根据用户的工件尺寸及重量，定做各种非标准吊钩式抛丸机。
We can design and manufacture all kinds of non-standard shot blasting machines according to customer different workpiece detail requirement, weight and productivity.

Product Features

This series is hook type shot blasting machine, is mainly used for surface cleaning of casting, structure, non-ferrous alloy and other parts. This series shot blasting machine have many types, such as single hook type, double hook type, lifting type, non-lifting type. It has advantage of non-pit, compact structure, high productivity, etc.

Q32系列履带式抛丸清理机

Q32 Series Tumble Belt Shot Blasting Machine



产品特点

该系列适用于各种中、小型铸件、锻件及机加工件的表面清理、除锈以及抛丸强化工艺。它适用于不同的生产规模，既可单机使用，也可多台联用，与连续输送器等配套组成生产清理流水线，是中、小型清理工件的理想清理设备。

Q32系列履带式抛丸清理机具有设计先进、结构合理、耗能小、效率高等优点。

应用示例 Application Case



◇ 技术参数 Technical Parameters

参数 Parameters	型号 Type	Q326	Q3210	QR3210
生产率 (T/h) Productivity		0.6-1.2	3-5	1.5-2.5
加料量 (kg) Loading weight		200	800	600
单件最大重量 (kg) The maximum weight of one piece		10	30	30
滚筒直径 (mm) Diameter of roller		Φ650	Φ1000	Φ1000
有效容积(m³) Available capacity		0.15	0.4	0.3
抛丸量 (kg/min) Pill impelling volume		125	360	250
除尘风量(m³/h) Dedusting air volume		2200	6000	5000
功率消耗 (kw) Power dissipation		12.6	32.6	24.3
外形尺寸 (mm) Appearance dimension		3200 × 1520 × 3500	4290 × 1900 × 4500	5850 × 1950 × 4600

Product Features

This series is used for surface cleaning, rust removing, product intensifying for all kinds of medium and small casting, forging and machinings. It is suitable for different process scale, can work single or multiple, can also conjunct with the continuous conveyor. It is the idea equipment for cleaning workpiece of medium and small sizes workpieces.

Q32 series tumble belt shot blasting machine has advantages of advanced design, reasonable structure, low energy consumption and high efficiency.

QT37系列环轨通过式抛丸清理机

Qt37 Series Circular Track Through Type Shot Blasting Machine



产品特点

该系列机型适合清理型钢、钢结构、钢板、建筑机械等大型焊接结构件，除掉其表面上的锈层、焊渣与氧化皮，消除内部的残余应力，使其获得均匀一致的金属光泽，以便提高钢材的涂饰质量与防腐效果。

应用示例 Application Case



◇ 技术参数 Technical Parameters

参数 Parameter	型号 Type	QT20H	QT50H	QT3740H	QT3720H
清理工件外形尺寸 (mm) The exterior size of cleaning casting		5880 × 3185 × 957	4000 × 3270 × 1320	Φ2500 × 4650	Φ2000 × 3200
抛丸器型号 The type of impeller head		XQH400	XQH400	XQH350	XQH300
功率 (kw) Power		8 × 18.5	8 × 18.5	8 × 15	12 × 11
抛丸量 (kg/min) The quantity of shot blasting		8 × 280	8 × 280	8 × 250	12 × 200
总功率 (不含除尘) (kw) Total power (except for dust cleaning)		187.4	187.4	148.3	168.3
总通风量 (m³/h) Total airrate volume		30000	30000	19000	38000
机器外形尺寸 (长 × 宽 × 高) (mm) The external dimension of machine (length × width × height)		18000 × 8150 × 11300	21000 × 7000 × 11509	14000 × 6200 × 7500 (地下 1650) under ground	19000 × 7200 × 7080 (地下 2150) under ground

可根据用户的工件尺寸及重量，定做各种非标准吊钩通过式抛丸机。
We can design and manufacture all kinds of non-standard shot blasting machines according to customer different workpiece detail requirement, weight and productivity.

Product Features

This series machine is suitable for cleaning steel profiles, steel structure, steel plate, construction machinery etc large welded structure parts, removing surface rust, welding slag and oxide skin, to eliminate the inside residual stress, and uniform metallic luster distribution, in order to improve the quality of coating in steel and anti-corrosion effect.

15/28 GN钢履带式抛丸机

15/28 GN Steel Crawler Shot Blasting Machine



产品特点

15GN钢履带式抛丸机用于清除铸、锻件、冲压件等易翻滚跌落的工件和不易撞碎的非脆性零件及型芯不深的铸件表面上的粘砂、锈层与氧化皮、毛刺。主要用户是机床厂、汽车厂、纺织机械厂、热处理车间、铸钢车间和冲压车间。由于该抛丸机型防护措施好，抛丸性能强，弹丸循环系统结构合理，对难以清理的工件也能取得满意的效果。

应用示例 Application Case



◇ 技术参数 Technical Parameters

参数 Parameter	型号 Type	15GN	28GN
有效工作容积 (m³) Effective working volume (m³)		0.43	0.79
尺寸(直径 × 长)(mm) Size (Diameter × Length)(mm)		Φ1092 × 1245	Φ1245 × 1778 mm
每桶最大装载量(kg) Maximum loading capacity per barrel(kg)		1362	3500 kg
最大单件重量(kg) Maximum single piece weight (kg)		227	363
卸料高度 (mm) Discharge height (mm)		1499	1545

Product Features

GN steel crawler shot blasting machine is used for removing adhering sand and scale, burr, rust of castings, forgings, stamping parts and other easy to roll and drop workpiece and not easy to crush the non-brittle parts and core is not deep casting parts. The main users are machine tool plant, automobile factory, textile machinery factory, heat treatment workshop, cast steel workshop and stamping workshop. As the shot blasting machine has good protective measures, strong shot blasting performance, shot recycling system is reasonable, can also achieve satisfactory results for the workpiece that difficult to clean.

转台式强化、抛丸清理机

Turntable Type Strengthening Shot Blasting Machine



产品特点

本机主要适用于铸锻件及热处理后的扁平、薄壁怕碰撞零件的表面清理，它可去除工件表面的粘砂、氧化皮等附着物，获得一定粗糙度的光亮表面，亦可用来说对某些齿轮，板簧件工件表面进行强化处理。

应用示例 Application Case



◇ 技术参数 Technical Parameters

参数 Parameter	型号 Type	Q3512	QF3512	QF3525E
清理室尺寸 (mm) Dimension of cleaning chamber		Φ1350 × 560	Φ1350 × 860	Φ2654 × 560
清理工件尺寸 (mm) Cleaning workpieces size		600 × 250 × 250	600 × 250 × 500	600 × 500 × 250
回转台车 Turntable car	载重量 (kg) Loading weight	400	400	1000
	直径 (mm) Diameter	Φ1200	Φ1200	Φ2500
抛丸器 Wheel blast equipment	抛丸量 (kg/min) Blasting capacity	200	2 × 120	2 × 250
	功率 (kw) Power	11	7.5 × 2	15 × 2
提升机提升量 (t/h) Lifting capacity of elevator		15	15	30
分离器分离量 (t/h) Separation quantity of separator		15	15	30
弹丸首次装入量 (kg) First loading quantity of shot		400	400	1500
通风量 (m³/h) Ventilation volume		2800	2800	5200
外形尺寸 (mm) External dimension		1500 × 3450 × 3780	1900 × 1900 × 4165	4260 × 3647 × 5366
功率 (不含除尘) (kw) Power (except for dust cleaning)		24.5	24.5	35.2

可根据用户的生产实际要求，设计制作各种非标准转台步进式、转台连续式、字母转台连续式抛丸及强化机。
We can design and manufacture all kinds of non-standard shot blasting machines according to customer different workpiece detail requirement, weight and productivity.

Product Features

This machine is mainly used for surface cleaning of casting and forging parts, flat, thin-wall parts which can't be collision after heat treatment. It can remove adhering sand, scale, etc attachments on surface of the workpiece, to obtain bright surface with a certain roughness. It can also be used for surface strengthen processing of some gear, plate spring, etc.

台车式抛丸清理机

Trolley Type Shot Blasting Machine



产品特点

该系列是台车式抛丸清理设备。利用抛丸器将高速弹丸抛向旋转台车上的工件表面，清除其表面上的粘砂、氧化皮及其它杂物，使之获得一定粗糙度的光亮表面。本机主要应用于机床、冶金工业、车辆、工程机械、矿山机械、和其他大型工件。

应用示例 Application Case



◇ 可根据用户的工件尺寸及规格、重量及生产节拍，设计制作各种非标准大吨位台车式抛丸机。

According to users' workpiece size and specification, weight and production efficiency, we can design and manufacture all kinds of non-standard large tonnage trolley type shot blasting machines.

Product Features

This is trolley shot blasting machine, utilize blasting wheel to throw the high-speed projectiles to the surface of workpiece on the rotating trolley, clean up the adhering sand, oxide scale and other sundries, the purpose is to obtain a certain roughness and bright surface. This machine mainly applies in machine tool, metallurgy industry, vehicle parts, construction machinery, mining machinery and other large workpiece.

全自动回收喷砂房

Automatic Recycling Sand Blasting Room



产品特点

全自动回收喷砂房是根据产品加工工艺流程及产品本身特性而设计的，适用于大型铸件锻件、焊接钢结构、工程机械、工业锅炉、化工机械、船舶修造等表面去氧化皮、除锈、强化，提高涂料的附着力等。其结构及配套设备主要由喷丸室、喷丸系统、磨料循环系统、通风和除尘系统、照明和电气控制系统六大部分组成。

应用示例 Application Case

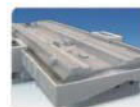

Product Features

Automatic recycling sand blasting room is designed according to the product processing process and the product characteristic, it is mainly used for large forgings and castings welded steel structure, engineering machinery, industrial boilers, chemical machinery, ship building, etc, to remove surface oxide skin, rust, and strengthen surface, to improve the coating adhesion, etc. This type machine is mainly composed of six parts: sand blasting chamber, sand blasting system, sand recycling system, ventilation and dust removal system, lighting and electrical control system.

喷漆房

Painting Room

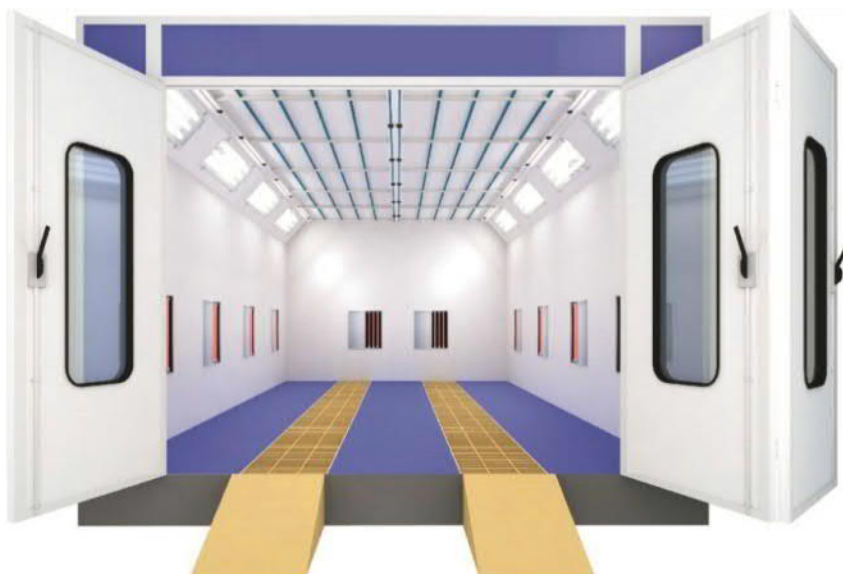

产品特点

喷漆作业的作业区，能够为喷漆作业提供符合油漆工艺条件的洁净风，保证作业区的微正压环境，且能够通过喷漆雾处理达到人员保护及环保排放要求的核心设备，可根据工件尺寸、生产纲领及工厂环境作非标设计，常用类型包括：湿式水旋喷漆房、湿式文氏喷漆房、湿式水帘喷漆房、干式喷漆房。

喷漆房

Painting Room



Product Features

Assignments area for painting job, it can supply clean wind in accordance with the paint process conditions, guarantee micro positive pressure environment, it is also the key equipment for meeting the requirements of personnel protection and environment protection through spray mist treatment. We can design non-standard machines according to workpiece size, production program and factory environment, common types include: Wet water rotary painting room, Wet venturi painting room, Wet curtain painting room, dry painting room.

移动式路面抛丸清理机

Mobile Type Road Surface Shot Blasting Machine



产品特点

路面抛丸机能够一次将混凝土的表面浮浆、杂质清理清除，并且可以对混凝土的表面进行打磨处理，使其表面均匀粗糙，大大提高了防水层和混凝土基层的黏着强度，以便防水层和桥面更好的结合，同时也能够将混凝土的裂纹充分暴露出来，起到防患于未然的作用。

应用示例 Application Case



◇ 技术参数 Technical Parameters

参数 Parameter	型号 Type	PHLM-270	PHLM-600	PHLM-800
抛丸宽幅mm Effective blasting width		270	600	800
行走速度m/min Traveling speed		0.5-20	0.5-20	0.5-20
抛丸效率m ² /h Production capacity		150	300	400
抛丸器功率 (KW) Total power		11	2*11	2*15
外形尺寸 (mm) Overall dimension (mm)		1000*300*1100	2050 *780 *1150	2050 *980 *1150
抛头数		1	2	2

Product Features

Road surface shot blasting machine can successively clear away the concrete surface laitance and impurities, and can do polishing processing to the concrete surface, make its surface to achieve uniform roughness. Greatly improve the adhesive strength of the waterproof layer and concrete base, so that better combine the waterproof layer and deck, also to be fully exposed concrete cracks, achieve nip in the bud.

皮带抛丸器 Belt Driven Shot Blasting Turbine



参数 型号 Parameter Type	叶轮直径 Diameter of Impeller(mm)	叶轮转速 Rotating speed of impeller(r/min)	最大抛丸量 Maximum capacity abrasive flow(kg/min)	电机功率 Motor power (kw)
Q034	420	2600	250	15
Q035	500	2250	360	22
Q035G	500	2250	480	30
Q038	500	2370	970	75

产品特点 Product Features

皮带抛丸器是一种传统的抛丸器，具有抛丸量大、清理效果好等优点，是大型清理设备的必备件。

Belt driven blast turbine is a conventional shot blasting wheel, the advantage is large rate abrasive flow and good cleaning effect, etc. It is the essential part of the large shot blast cleaning equipment.

直联抛丸器 Direct-driven Shot Blasting Turbine



参数 型号 Parameter Type	叶轮直径 Diameter of Impeller(mm)	叶轮转速 Rotating speed of impeller(r/min)	最大抛丸量 Maximum capacity abrasive flow(kg/min)	电机功率 Motor power (kw)
ZLQ034	380	2940	120	7.5
SQ033	400	2450	180	11
Q034B	380	2940	250	15

产品特点 Product Features

直联抛丸器是一种新型、高效的抛丸器，具有外形美观、结构紧凑、噪音低、节能环保等特点。

Direct driven blast turbine is a high-efficient blast wheel, the advantage is beautiful appearance, compact configuration, low noise, economy and environmental protection. Has the largest power and largest abrasive flow rate. It is widely used in all kinds of shot blasting cleaning machine.

曲面叶片抛丸器 Curved Blade Shot Blasting Turbine



参数 型号 Parameter Type	叶轮直径 Diameter of Impeller(mm)	叶轮转速 Rotating speed of impeller(r/min)	最大抛丸量 Maximum capacity abrasive flow(kg/min)	电机功率 Motor power (kw)
Q63Z11	300(one)	2940	180	11
Q63Z15	300(one)	2940	240	15
Q63Z18.5	300(one)	2940	300	18.5
Q63Z22	300(one)	2940	350	22

产品特点 Product Features

曲面叶片抛丸器是目前国际上最先进的抛丸器，具有抛丸速度大、效率高、抛射面积大、抛射清理均匀等优点。

Curve blade shot blasting turbine is the most advanced high-efficiency shot blasting wheel at the moment, the advantage is huge blast speed, efficient, large mass ejection area and uniform clean, etc.

配件 Spare Part



脉冲袋式除尘设备

Pulse Bag Dust Removal Equipment



产品特点

脉冲袋式除尘设备，是我公司在消化吸收英国先进技术的基础上设计制造的新型除尘器。可根据用户处理的含尘气体的特点，选用具有针对性的滤袋；解决高温、粘性、含水量大及有尘爆危险的粉尘过滤问题，广泛应用于冶金、化工、机械、木业、建材、轻工、制药、粮食等产业。



◇ 技术参数 Technical Parameters

参数 Parameter		型号 Type	MC200	MC250	MC300	MC350	MC400
过滤面积 (m ²) Filtration area			200	250	300	350	400
处理风量 (m ³ /h) Disposal air quantity			26400	33000	39600	46200	52800
滤袋规格 Sieve bag specification	直径 Diameter		130	130	130	130	130
	长度 Length		2500	2500	2500	2500	2500
滤袋数量 (条) Sieving bag quantity			200	250	300	350	400
过滤风速 (m/min) Filtration wind speed			1.2-2.0				
除尘效率 (%) Removing dust efficiency			99.5				

Product Features

This kind of dust collector is a new type and is designed through introducing UK advanced technology. We could choose special sieve bag to solve some relevant problems. This kind of dust collect is used for metallurgy, chemical, machinery, wood industry, light industry, pharmacy industry, and food industries and so on.

滤筒式除尘设备

The Filter Cartridge Dust Removal Equipment



产品特点

滤筒式除尘设备主要用于悬浮的微粒和粉尘的收集，无论用于空气污染控制或作为生产过程的一部分，它都能高效连续在线的粉收集。该机具有运行稳定，处理风量大，体积小，维修方便等优点。



◇ 技术参数 Technical Parameters

参数 Parameter	型号 Type	除尘风量 Removing dust air volume	过滤面积 m ² Filtration area	引风机功率 kw Induced draft fan rate
	HR-4	3000	80	5.5
	HR-8	6000	120	7.5
	HR-12	9000	180	11
	HR-16	12000	240	22
	HR-24	18000	360	22
	HR-32	24000	480	30
	HR-36	27000	540	37
	HR-40	30000	600	37
	HR-48	38000	720	37
	HR-56	42000	840	45
	HR-64	56000	860	45

Product Features

Cartridge filter is mainly used for the collection of suspended particles and dust, whether used in air pollution control or as part of the production process, both can be continuous and efficient collection. Its advantage is stable operation, process air volume, small size and easy maintenance.

消失模铸造生产线

EPC Production Line



应用示例 Application Case



产品特点 Product Features

消失模铸造是一种优质、高效、低耗、节能的第三代造型方法，将与铸造尺寸相似、形状相似的泡沫塑料模型或模型簇涂刷耐火图层，烘干后置于专用沙箱内，填入不含任何辅助材料的干砂中，微震坚实，在负压下浇注成型的铸造新工艺。

EPC is a New Casting Technique, it's a third-generation modeling method with high quality, high efficiency, low consumption, energy-saving. First make the foam model or cluster model which is similar to the casting size and shape painting refractory layers, placed in special sandbox after drying, then filled into the dry sand which is without any auxiliary materials, microseismic solid and moulding by casting under negative pressure.

V法铸造生产线

V-Process Casting Production Line



应用示例 Application Case



产品特点 Product Features

V法铸造可以适用于铸钢、铸铁、有色金属等各种材质的铸件。它以尺寸精度高、表面粗糙度低、铸造缺陷少、操作简便、成本低廉、型砂无需混制等优点越来越受到国内铸造行业青睐。

V-Process casting production line is suitable for casting with material of cast steel, cast iron, non-ferrous metal, etc. The advantage is High dimensional accuracy, Low surface roughness, Less casting defects, Easy to operate, Low cost and without sand mixed system, etc. More and more favored by domestic casting industry.



数控锻压及自动化系列

CNC FORGING & AUTOMATION

专注于为用户打造
最具性价比的产品价值与服务.....

Focus on the best service and most cost performance product value...

WINCOO ENGINEERING CO.,LTD

AMD-357 闭式液压数控转塔冲床

AMD-357 Closed Type Hydraulic CNC Turret Punch Machine

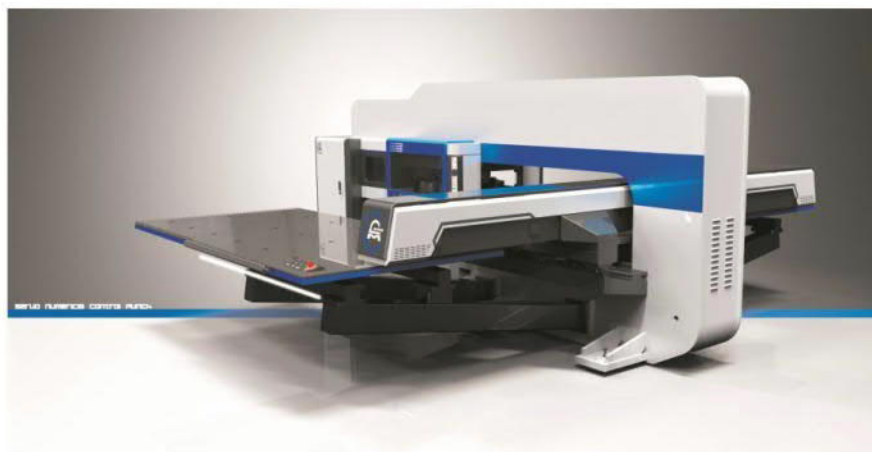

产品特点

- 旋转工位功能有效解决不规则角度的剪切困难;
- 采用德国西门子数控冲床专用系统, 配合数字交流伺服电机, 速度更快稳定性更高;
- 钢板焊接的闭式床身, 经整体回火处理, 刚性好、变形小;
- 高水准的数字式液压主传动系统, 速度更快、行程可调;
- 配备二次定位系统, 加工时夹钳自动避让, 可实现无死区加工;
- 传动系统采用国际品牌的高精度、大导程滚珠丝杠、直线导轨, 精度高。性能好;
- 主要气动元件、电气元件、液压元件采用国际知名品牌, 使机床性能更趋完美;
- 采用AMADA标准铸造一体式厚转塔模盘和AMADA标准厚转塔国际通用模具。

主要部件 Main Parts



◇ 技术参数 Technical Parameters

参数 Specification	单位 Unit	AMD-357
传动模式 Transmission Mode	/	液压传动
公称力 Punch Force	KN	300 / 500
额定功率 Power Rating	KW	20
加工板材尺寸 Processing Sheet Size	mm	2500*1250
加工板材厚度 Processing Sheet Thickness	mm	≤6
最大冲孔直径 Max Punch Diameter	mm	Φ88.9
板料移动速度 Sheet Moving Speed	m/min	60
冲孔频率 Punching Frequency	hpm	800
冲孔精度 Hole Accuracy	mm	±0.1
工位数 Number Of Stations In Turret	No.	16/24/32
转速速度 Turret Speed	rpm	30
控制轴数 Controlled Axis	No.	3/4
旋转工位 Rotating location	No.	0/2
空气压力 Air Pressure	mpa	≥0.8
外形尺寸 Outline Dimension	mm	4490*5300*2110
机器重量 Machine Weight	T	13

Product Features

- Auto-index station function effectively solve irregular angle's shear difficulties.
- Adopts Siemens CNC special system and match up digital AC servo motor to make it fast and reliable.
- O type steel plate welding press, the whole pass by tempering treatment to own good rigid and hardly deformation.
- High precision digital hydraulic main transmission system, speed is faster, stroke is adjustable.
- Equipped with the second positioning function, processing, the clamp automatically avoid, which can achieve without dead zone processing.
- The transmission system use the international brand with high precision, long guide ball screw, linear guide rail are high precision and good performance.
- Main pneumatic components, electric components, hydraulic components adopt international well-known brand products, which makes the punch press performance more perfectly.
- Use AMADA standards casting integrated type thick turret mold disc and standards thick turret international molds.

AMD-357 闭式机械数控转塔冲床

Closed Type Mechanical CNC Turret Punch Machine AMD-357



产品特点

- 传动系统采用国际品牌的高精度、大导程滚珠丝杠、直线导轨，精度高、性能好；
- 采用德国西门子系统，配合数字交流伺服电机，速度快、可靠性好；
- 主要气动元件、电气元件采用国际知名品牌，使机床性能更趋完美；
- 高精度厚转盘有效提高了转盘的精度及寿命，并有16/24/32工位可供用户选择；
- 模具采用先进的加工及热处理工艺，使用寿命长；
- 集中润滑装置，减少各运付的摩擦，提高机器使用寿命；
- 整体式横梁结构，拖板与横梁一体化设计，增强刚性，定位精准，高速送料更平稳，杜绝工作台X、Y轴动态偏移情况。

主要部件 Main Parts



◇ 技术参数 Technical Parameters

参数Specification	单位Unit	AMD-357
公称力Punch Force	KN	250/300
额定功率Power Rating	KW	11/13
加工板材尺寸Processing Sheet Size	mm	2500*1250
加工板材厚度Processing Sheet Thickness	mm	≤4
最大冲孔直径Max Punch Diameter	mm	Φ88.9
板料移动速度Sheet Moving Speed	m/min	60
冲孔频率Punching Frequency	hpm	270
孔距精度Hole Accuracy	mm	±0.1
工位数Number Of Stations In Turret No.		16/24/32
转盘速度Turret Speed	rpm	30
控制轴数Controlled Axis	No.	3/4
空气压力Air Pressure	mpa	≥0.8
外形尺寸Outline Dimension	mm	4490*5300*2110
机器重量Machine Weight	T	12/13

Product Features

- The transmission system use the international brand with high precision, long guide ball screw, linear guide rail are high precision and good performance.
- Adopts Siemens system and match up digital AC servo motor to make it fast and reliable.
- Main pneumatic components, electric components and other parts adopt international well-known brand products, which makes the punch press performance more perfectly.
- High precision thick turret mold disc improve the mold disc precision and service life, and there are 12/16/24/32 stations for customers choice.
- Mold adopts advanced processing and preheating technology, prolong service life.
- Centralized lubricating device, reduce each kinematic pair friction, prolong the press service life
- Integrated trabeation, flank and trabeation integrated design, strengthen rigidity, positioning accuracy, high-speed feeding is more stable, prevent the workbench X, Y axis dynamic deviation.

伺服式数控转塔冲床

Servo Type CNC Turret Punching Machine

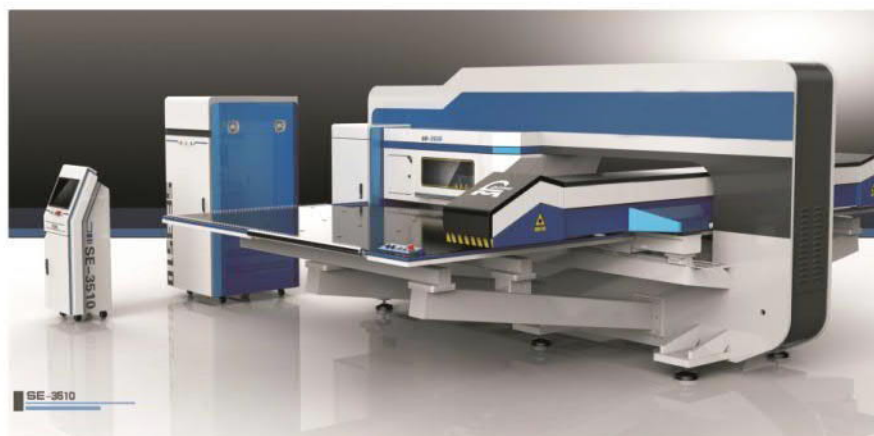

产品特点

- 采用西班牙法格系统和伺服模块，扭矩大，响应快，精度高。
- X轴采用双导轨导向，齿轮齿条传动，高速平稳精度高，达到国际水准。
- 五轴全电动控制，实现冲压，拉伸，滚压成型等工艺，适用于精密钣金加工。
- 节能，待机无电消耗，有效的降低能耗；可选择柔模式，静音环保。

主要部件 Main Parts



◇ 技术参数 Technical Parameters

参数Specification	单位Unit	规格型号	
		AMD-SE2510	AMD-SE3510
公称力Punch Force	KN	200	300
最大板材加工尺寸Max. Processing Size	mm	1250*1250	1250*1250
		1250*2500	1250*2500
		1250*5000	1250*5000
最大板材加工厚度Max. Sheet Thickness	mm	4	6
冲孔频率Punching Frequency	hpm	1600	1600
板料最大移动速度Max. Sheet Traversing Speed	m/min	80	80
转盘速度Turret Speed	rpm	40	40
孔距精度Hole Accuracy	mm	±0.1	±0.1
最大冲孔直径Max Punch Diameter	mm	Φ88.9	Φ88.9
工位数Number Of Stations In Turret	No.	24 / 32	24 / 32
空气压力Air Pressure	mpa	0.8	0.8
控制轴数Controlled Axis	No.	4(X,Y,C,A)	4(X,Y,C,A)
额定功率Power Rating	KW	30	35
外形尺寸Outline Dimension	mm	4490*5300*2110	4490*5300*2110
机器重量Machine Weight	T	13	14

Product Features

- Adopts Spain Fagor system and servo module, with quick response and high precision.
- X axis adopts double guide rail for guiding, gear rack for driving, it is very stable with high-speed and high precision, reached the international level.
- Five-axis all electric control, can realize punching, stretching, and roller forming etc technology, it is suitable for precision sheet metal processing.
- Energy conservation, standby without electricity consumption, effectively reduce energy consumption; Can choose downy mode, quiet and environment protection.

开式机械数控转塔冲床 AMD-2510

Open Type Mechanical CNC Turret Punch Machine AMD-2510



产品特点

- 国内研发专利一飞轮内置式数控转塔冲床，双C型机架采用日本技术，整机回火处理，有效的消除内应力，增加设备刚性，减小变形；
- 采用德国西门子数控冲床专用系统，配合数字交流伺服电机，相应速度更快、可靠性更高；操作灵活方便，无需人工编程；配有二次定位功能，夹钳可自动避让，实现无死区加工；
- 飞轮内置，曲轴纵放，滑套式打击头配合进口离合器，冲压频率更高，外形更加美观；
- 采用AMD标准铸造一体式厚转塔模盘和AMD标准厚转塔国际通用模具；
- 伺服电机、直线导轨、滚珠丝杠、气动元件及电气元件均采用进口品牌；
- 采用AMD标准浮动式气动夹钳，冲压时与板料一起上下浮动，有效消除冲压余力，提高加工精度；
- 配有集中自动润滑系统，各润滑点均能实现自动集中润滑，有效的延长设备使用寿命。

主要部件 Main Parts



◇ 技术参数 Technical Parameters

参数Specification	单位Unit	AMD-2510
公称力Punch Force	KN	250
额定功率Power Rating	KW	11
额定电压Voltage Rating	V	380 ± 5%
加工板材尺寸Processing Sheet Size	mm	2500*1250
加工板材厚度Processing Sheet Thickness	mm	≤3
最大冲孔直径Max Punch Diameter	mm	Φ88.9
板料移动速度Sheet Moving Speed	m/min	60
冲孔频率Punching Frequency	hpm	270
孔距精度Hole Accuracy	mm	±0.1
工位数量Number Of Stations In Turret	No.	16/24
转盘速度Turret Speed	rpm	30
控制轴数Controlled Axis	No.	3
空气压力Air Pressure	mpa	≥0.8
外形尺寸Outline Dimension	mm	4880*2600*2050
机器重量Machine Weight	T	10

Product Features

- Research and development of domestic patent, built-in flywheel type CNC turret punching machine, double C-type press adopts Japanese technology, the whole pass by tempering treatment to own good rigid and hardly deformation
- Adopts Siemens CNC special system and match up digital AC servo motor to make it faster and more reliable. Operation is easy, no need manual programming and processing, equipped with the second positioning function, the clamp automatically avoid, which can achieve without dead zone processing.
- The built-in flywheel, crankshaft put in longitudinal, sliding type strike head equipped with imported clutch, the stamping frequency is higher, appearance is more beautiful.
- Use AMADA standards casting integrated type thick turret mold disc and standards thick turret international molds.
- Servo motor, linear guide rail, ball screw, pneumatic components and electrical parts adopt imported brand.
- Adopts AMADA standard float type pneumatic clamp, punching, sheet can float up and down together, effectively eliminate stamping spare capacity, improve processing precision.
- Using centralized lubricating system, each lubricating point can achieve automatic centralized lubrication, effectively prolong service life.

开式机械数控转塔冲床 AMD-255

Open Type CNC Turret Punch Machine AMD-255



产品特点

- 经济型飞轮外置式数控转塔冲床，采用先进数控冲床专用系统，配合数字交流伺服电机，速度更快稳定性更高；
- 采用进口品牌伺服电机、导轨、丝杠、电气元件、气动元件；
- 采用进口离合器，刹车及时上下死点定位准确；
- 采用AMD标准铸造一体式厚转塔模盘和AMD标准后转塔国际通用模具；
- 采用全浮动式气动夹钳，冲压时与板材同时上下浮动，有效消除冲压余力，提高加工精度；
- 配有自动集中润滑装置，降低了各运动副间的摩擦，提高设备使用寿命。

主要部件 Main Parts



◇ 技术参数 Technical Parameters

参数Specification	单位Unit	AMD-255
公称力Punch Force	KN	250
额定功率Power Rating	KW	11
额定电压Voltage Rating	V	380 ± 5%
加工板材尺寸Processing Sheet Size	mm	2500*1250
加工板材厚度Processing Sheet Thickness	mm	≤ 3
最大冲孔直径Max Punch Diameter	mm	Φ88.9
板料移动速度Sheet Moving Speed	m/min	60
冲孔频率Punching Frequency	hpm	270
孔距精度Hole Accuracy	mm	± 0.1
工位数Number Of Stations In Turret	No.	16/24
转盘速度Turret Speed	rpm	30
控制轴数Controlled Axis	No.	3
空气压力Air Pressure	mpa	≥ 0.8
外形尺寸Outline Dimension	mm	4910*3300*2225
机器重量Machine Weight	T	7.5

Product Features

- Economy type built-in flywheel CNC turret punching machine, adopts Germany advanced numerical control special system, equipped with digital AC servo motor, speed is more faster and stability is higher.
- Adopt imported brand servo motor, guide rail, screw, electrical component and pneumatic component.
- Adopt imported clutch, brake in time, top and bottom dead point positioning accuracy.
- Adopts AMADA standard casting integrated type thick turret mold disc and AMADA standard thick turret international molds.
- Adopt full float type pneumatic clamp, punching, sheet can float up and down together, effectively eliminate stamping spare capacity, improve processing precision.
- Equipped with concentrated lubricating device, reduce kinematic pair friction, improve service life.

开式液压数控转塔冲床 AMD-3510

Open Type Hydraulic CNC Turret Punch Machine AMD-3510



产品特点

- 高水准的数字式液压主传动系统，速度快、行程可调；
- 采用德国西门子数控冲床专用系统，配合数字交流伺服电机，响应速度更快、可靠性更高；操作灵活方便，无需人工编程；配有二次定位功能，可实现无死区加工；
- 采用AMD标准铸造一体式厚转塔模盘和AMD标准厚转塔国际通用模盘；
- 配有集中润滑装置，有效的减少各种运动副的摩擦，提高设备使用寿命。

主要部件 Main Parts



◇ 技术参数 Technical Parameters

参数Specification	单位Unit	AMD-3510
传动模式Transmission Mode	/	液压传动
公称力Punch Force	KN	250
额定功率Power Rating	KW	20
额定电压Voltage Rating	V	380±5%
加工板材尺寸Processing Sheet Size	mm	2500*1250
加工板材厚度Processing Sheet Thickness	mm	≤6
最大冲孔直径Max Punch Diameter	mm	Φ88.9
板料移动速度Sheet Moving Speed	m/min	60
冲孔频率Punching Frequency	hpm	350—600
孔距精度Hole Accuracy	mm	±0.1
工位数Number Of Stations In Turret	No.	16/24
转速速度Turret Speed	rpm	30
控制轴数Controlled Axis	No.	3
空气压力Air Pressure	mpa	≥0.8
外形尺寸Outline Dimension	mm	5060*3300*2030
机器重量Machine Weight	T	10

Product Features

- Equipped with high precision hydraulic initiative transmission system , speed faster,travel is adjustable.
- Adopts simens CNC special system and match up digital AC servo motor to make it fast and reliable, operation is easy, no need manual programming and processing, with the second positioning function, can achieve without dead zone processing.
- Use AMD standards casting integrated thick turret mold disc and AMD standards thick turret internationally used mould.
- Equipped with concentrated lubricating device, reduce each motion vice friction,improve service life.

重荷载特钢数控冲压设备

Hydraulic Thick Plate CNC Turret Punching Machine



产品特点

- 采用我公司研发的直列式模架，配合厚板冲压专用模具，加工板材厚度达16mm；
- 高水准的数字式液压主传动系统，高低压自动切换，冲压力大、速度快、行程可调；
- 采用德国西门子数控系统，配合数字交流伺服电机，响应速度更快、可靠性更高；操作灵活方便，无需人工编程，一键式操作，特备适合批量生产；
- 配有集中润滑装置，有效的减少各运动副的摩擦，提高机器使用寿命；



◇ 技术参数 Technical Parameters

参数 Specification 名称 Name	型号 Type	AMD-HB40	AMD-HB50	AMD-HB60	AMD-HB80	AMD-HB100	AMD-HB120	AMD-HB160	
公称力 Punch force		40T	50T	60T	80T	80T	100T	120T	160T
机床结构 Machine structure		开式 open type				闭式 closed type			
最大加工板厚 Max. Processing thickness		35mm							
加工范围 Working Range		1500 × 800mm/3000 × 1600mm							
夹钳数量 Clamp amount		2—3个							
最高冲压速度 Punching frequency		120HPM		80HPM		80HPM	80HPM	80HPM	60HPM
工作台速度 Turret speed		≤40m/min							
加工精度 Processing precision		±0.15mm							
气源流量 Air Ventilation		0.1m³/min							
气源压力 Air pressure		0.5MPa (5.0kgf/cm2)							
电源 Power		380V ± 5%/50HZ							
工位数 Number of stations in turret		3—12个 (可选配) Optional							

Product Features

- Using in-line type die set which researched and developed by our company, matching with thick plate stamping dedicated mould, the processing sheet thickness can up to 16 mm;
- Equipped with high precision hydraulic main transmission system, speed is faster, stroke is adjustable.
- Adopts Siemens CNC special system and match up digital AC servo motor to make it faster and reliable, operation is easy, no need manual programming and processing, with the second positioning function, can achieve no dead zone processing
- Equipped with concentrated lubricating device, reduce each kinematic pair friction, improve machine service life.

汽车大梁数控冲孔生产线

Car Girder Cnc Punching Production Line



产品特点

- 自动上料、下料，自动码块；
- 模具自动转换，模具拆装简单；
- 夹钳自动避让功能，无死区加工；
- 可移动废料小车，可吊运，安装灵活、快捷；
- 自动测宽，自动计算，中心线定位，长度方向自动定位；
- 主机结构床身为闭式O型高刚性焊接床身，承受冲压力，床身经过有限元分析验证；
- 板材完全自动化加工；样冲功能，断点续冲功能，真正的图形显示功能，生产数据的显示功能；采用浮动夹钳，减少意外情况下的部件损坏；模具拆装简单，监控措施完善，环保安全。除必要的维护时间外，可连续工作；进口数控系统操作简单功能齐全。



◆ 技术参数 Technical Parameters

参数Specification	单位Unit	AMD—DLC7500/8000	AMD—DLC7500/8000
冲压力Punch force	KN	1200	1200
最大加工板材重量 Max. Weight of processing sheet	Kg	320	510
最大加工板材尺寸Max. Size of processing sheet	mm	7500*550 8000*550	10000*550 12000*550
加工板材厚度Processing sheet thickness	mm	10	10
X/Y向送料行程X/Y direction feeding range	mm	X=7500/8000 Y=550	X=10000/12000 Y=550
冲孔频率Punching frequency	r/min	80	80
板材最大移动速度Max. Sheet moving speed	m/min	≤30	≤30
孔距精度Hole accuracy	mm	±0.1	±0.1
气源Air source		压力0.5Mpa	流量0.1m3/min
电压Voltage	V/Hz	380±5%/50HZ	

简易型数控冲床 AMD-PQ

Simple Type CNC Turret Punch Machine AMD-PQ

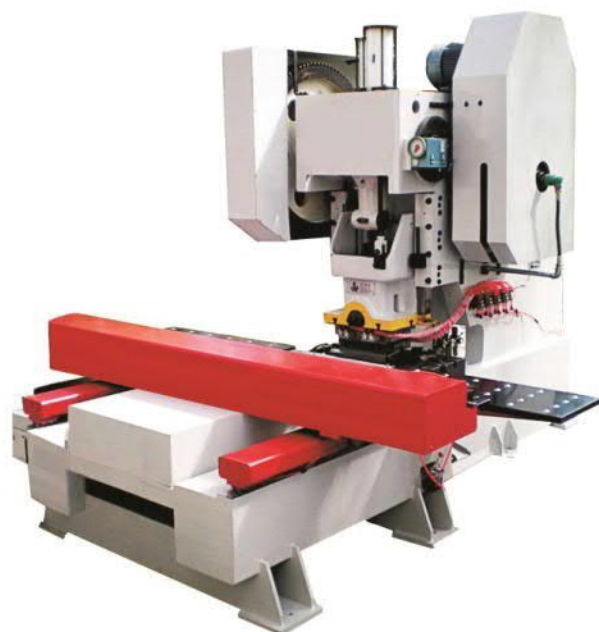

产品特点

- 工业电脑数控系统，阿玛达公司独立开发的数控加工软件，可实现现场编程、后台编辑；19寸品牌液晶显示器，画面更加清晰美观；软件操作灵活方便，自带模具库管理，可识别CAD图纸自动生成CNC代码，实现自动编程、自动送料、自动冲压，速度快、精度高；
- 采用我公司独立研发的直列式模架，可实现自动换模，配国际标准通用模具，更换方便；
- 伺服电机、直线导轨、滚珠丝杠、联轴器、气动元件及电器件均采用进口品牌，保证了机床精度几稳定性；
- 采用集中润滑系统，丝杠、导轨等主要传动部件均能集中润滑，延长设备使用寿命；
- 平台特殊加强设计，宽导轨间距，提高了机床的运行稳定性，保证了加工大板厚板的精度。

主要部件 Main Parts



◇ 技术参数 Technical Parameters

参数Specification	单位Unit	AMD-PQ
公称力Punch Force	KN	250/400/630
额定功率Power Rating	KW	8/9.5/11
额定电压Voltage Rating	V	380 ± 5%
最大加工板材尺寸Max. Processing Size	mm	2500*1250
加工板材厚度Processing Sheet Thickness	mm	≤ 6
板料最大移动速度Max. Moving Speed	m/min	60
冲孔频率Punching Frequency	hpm	130/100
孔距精度Hole Accuracy	mm	± 0.1
模位数Number Of Stations In Turret	No.	4/6/8
外形尺寸Outline Dimension	mm	4700*3900*2250
机器重量Machine Weight	T	6/7.2/8.5

Product Features

- Industrial computer (IPC) system, AMADA company developed CNC processing software, can achieve field programming, backstage programming, 19 inch brand LCD monitor, the picture is more clear and beautiful; Software is convenient operation, bring their own mold library management, can identify CAD drawings automatically generate CNC code, and realize the automatic programming, automatic feeding, automatic stamping, high speed, high accuracy.
- Adopts our company independent research and development the in-line arrangement mold frame, can realize the automatic changing mold, match the international standard mold and easy to change.
- Servo motor, linear guide rail, ball screw, coupling and pneumatic components and electrical parts are imported brand, ensure the machines accuracy and stability
- Use centralized lubricating system, automatic return oil, ball screw, guide and other major transmission parts are centralized lubrication, prolong the press service life
- Plate specially enhance the design, with wide guide rail, which improve the press operation stability and fully guarantee the accuracy of big sheet processing.

平台型数控冲床 AMD-P

Platform CNC Turret Punch Machine AMD-P



产品特点

- 工业电脑数控系统，阿玛达公司研发的数控加工软件，可实现现场编辑、后台编辑；宽屏液晶显示器，画面更加清晰美观；
- 进口品牌伺服电机，进口精密双直线导轨，保证精度高，使用寿命长；进口联轴器，保证持久耐用，校正系数高；进口大导程高精度滚珠丝杠，保证加工精度、运行速度快；
- 可实现AutoCAD图形自动转换为加工代码，无需人工编程，也可用G代码直接编程加工；CAD绘图中设置有模具库选择，并可在CAD文件中预览图文，简单易学，功能齐全；
- 宽导轨间距设计，提高了机床的运行稳定性，保证加工大板厚板的精度；焊接床身，整体回火处理，消除内应力，保证了机床的长期稳定性；平台特殊加强设计，高强度支撑，结构紧凑，运行平稳；
- 配有集中润滑泵，将润滑油直接送入各润滑点，减少各运动副的摩擦，提高使用寿命。

主要部件 Main Parts



◇ 技术参数 Technical Parameters

参数Specification	单位Unit	AMD-P10	AMD-P20	AMD-P25	AMD-P30	AMD-P35
公称力Punch Force	KN	根据加工板材需要的冲压力				
加工板材厚度Processing Sheet Thickness	mm	≤6				
加工板材尺寸Processing Sheet Size	mm	1000*1000	1000*2000	1250*2500	3500*1250	3500*1250
冲孔频率Punching Frequency	hpm	150				
板料移动速度Sheet Moving Speed	m/min	40				
孔距精度Hole Accuracy	mm	±0.1	±0.1	±0.1	±0.1	±0.1
额定电压Voltage Rating	V	380±5%	380±5%	380±5%	380±5%	380±5%
额定功率Power Rating	KW	2	3	3.5	4	4.5
机器重量Machine Weight	T	3.3	4.2	5	5.8	6.2

Product Features

- Industrial computer (IPC) system, AMADA company developed CNC processing software, can achieve field programming, backstage programming, wide screen LCD monitor, the pictures are more clear and beautiful.
- Import brand servo motor: Imported precision double linear guide, ensure high precision, long service life; Import coupling, ensure durability, calibration coefficient high; Imported precision long guide high-precision ball screw, ensure the high accuracy processing and fast speed.
- Can realize AutoCAD diagram automatically convert to processing code, no need manual programming, also can use G code directly programming and processing; In the CAD drawing, set the mold library choice, and can preview diagram in the CAD file, easy to operate, complete functions.
- Wide guide design, improve the operation stability of machine, guarantee the press accuracy of processing big sheet and thickness sheet. Welding press, the whole pass by tempering treatment, eliminate stress, guarantee the long-term stability of the machine; Platform special strengthen design, high strength support, compact structure, smooth operation.
- Equipped with concentrated lubrication pump oil, directly send lubricating oil to each lubricating point, reduce each kinematic pair friction and improve service life.

剪板机前数控送料 AMD-JB

CNC Steel Plate Shearer Front Feeding AMD-JB



产品特点

- 采用国内先进数控系统，操作灵活方便，无需人工编程，终身可免费升级；
- 伺服电机、直线导轨、滚珠丝杠、联轴器、气动元件及电气元件均采用进口品牌；
- 采用气动式加长夹钳，工作效率高，加工死区小；
- 万向球工作平台，摩擦力小、支撑效果好；
- 机床导轨跨距大，两边可配置升降辅助平台，方便人工装卸平台，并对较薄板材有非常好的支撑效果；
- 电器柜与床身一体化设计，减少了床身与外部的连接线路，便于运输、维护，同时减少了故障率；
- 板材可在程序执行完毕后自动重复定位，可实现大批量板材加工；批量加工时，可实现一键式操作，方便快捷。

主要部件 Main Parts



◇ 技术参数 Technical Parameters

参数 Specification	单位 Unit	AMD-JBS25	AMD-JBS32
可剪板材尺寸 Biggest Sheet Size Can Be Cut	mm	2500*2500	3200*2500
送料最大行程 Feeding Schedule	mm	2500	3200
送料精度 Feed Accuracy	mm	± 0.1	± 0.1
额定功率 Power Rating	KW	3	3
夹钳 Clamp Forceps	NO.	3	3
外形尺寸 Outline Dimension	mm	3200*2600*820	3900*2600*820
机器重量 Machine Weight	T	1	1.5

Product Features

- Adopts inland advanced numerical control system, convenient operation, no need manual programming, whole life long can be free upgrades;
- Servo motor, linear guide rail, ball screw, coupling and pneumatic components and electrical parts were imported brand;
- Adopt pneumatic type extended clamp, the working efficiency is high, the processing dead zone is small;
- Universal ball working platform, friction small, supporting effect good;
- Machine with wide guide rail and with large span, both sides can be equipped promotion and demotion auxiliary platform, convenient workers loading and unloading plate, and have very good support effect for a thin plank;
- Electrical cabinet and lathe bed adopt integrated design, reduce the machine tool and the external connecting link, easy to transport and maintenance, meanwhile reduce the failure rate;
- Plate can be repeated positioning after the completion of program execution, accurate positioning, can realize quantities plate processing; Batch processing, can achieve a key type operation, convenient and quickly.

数控剪板机 AMD-SKJ

CNC Shearing Machine AMD-SKJ



适用范围

- 采用全钢焊接结构，综合处理（振动时效、热处理）消除内应力，有较好的刚性与稳定性；
- 采用先进的集成式液压系统，可靠性好；
- 消除导轨间隙，提高剪切质量；机动后挡料，手动微调，数字显示；
- 刀片间隙有手轮调整，迅速、准确、方便；
- 矩形刀片，四个刃口均可使用，使用寿命长，剪切角可调，减少板料扭曲变形；
- 上刀架采用内倾结构，便于落料，并能提高工作精度；
- 具有分段剪切功能，具有灯光照明装置功能；
- 后托料装置（可另选择配置）。

◇ 技术参数 Technical Parameters

名称 Parameter	可剪板厚 Shearing Thickness	可剪板宽 Shearing Width	行程次数 Strokes	后挡料行程 Backgauge Range	剪切角度 Shearing Angle	工作台高度 Working table height	电机功率 Motor power
规格 Specification	mm	mm	time/min	mm	(°)	mm	KW
Q11Y6 × 2500	6	2500	16-35	20-600	30° -1° 30'	800	7.5
Q11Y6 × 3200	6	3200	14-35	20-600	30° -1° 30'	800	7.5
Q11Y6 × 4000	6	4000	10-30	20-600	30° -1° 30'	800	7.5
Q11Y6 × 5000	6	5000	10-30	20-800	30° -1° 30'	900	11
Q11Y6 × 6000	6	6000	8-5	20-800	30° -1° 30'	1000	11
Q11Y8 × 2500	8	2500	14-30	20-600	30° -2°	800	11
Q11Y8 × 3200	8	3200	12-30	20-600	30° -2°	850	11
Q11Y8 × 4000	8	4000	10-25	20-600	30° -2°	900	11
Q11Y8 × 5000	8	5000	10-25	20-800	30° -2°	1000	15
Q11Y8 × 6000	8	6000	8-20	20-800	30° -2°	1050	15
Q11Y12 × 2500	12	2500	12-25	20-800	30° -2°	840	15
Q11Y12 × 3200	12	3200	12-25	20-800	30° -2°	900	15
Q11Y12 × 4000	12	400	8-20	20-800	30° -2°	940	15
Q11Y12 × 5000	12	5000	8-20	20-1000	30° -2°	1000	22
Q11Y12 × 6000	12	6000	6-20	20-1000	30° -2°	1060	30
Q11Y16 × 2500	16	2500	12-20	20-800	30° -1° 30'	840	22
Q11Y16 × 3200	16	3200	12-20	20-800	30° -1° 30'	900	22
Q11Y16 × 4000	16	4000	8-15	20-800	30° -1° 30'	940	22
Q11Y16 × 5000	16	5000	8-15	20-1000	30° -1° 30'	1000	30
Q11Y16 × 6000	16	6000	8-15	20-1000	30° -1° 30'	1100	37
Q11Y20 × 2500	20	2500	10-20	20-800	30° -3°	900	30
Q11Y20 × 3200	20	3200	10-20	20-800	30° -3°	950	30
Q11Y20 × 4000	20	4000	8-15	20-800	30° -3°	1100	30
Q11Y20 × 5000	20	5000	8-15	20-1000	30° -3°	1100	37
Q11Y20 × 6000	20	6000	6-15	20-1000	30° -3°	1200	37

Product Features

- The whole steel welding structure, integrated treatment (vibration aging, heat treatment) eliminate stress, have very good rigidity stability;
- Adopts advanced integrated hydraulic system, good reliability;
- Eliminate guide rail gap and raise the quality of shear; After motor file material, manual tuning, digital display;
- The blade gap has the handwheel adjustment, rapid, accurate and convenient;
- Rectangular blade, the convenient handwheel adjustment and long service life. Shearing angle adjustable, reduce the deformation sheet metal distortion;
- On the NaQing tool structure, easy to dropping material, and can improve the precision of the work;
- Has the segmentation shearing functions; With lamplight illum device function;
- After mixture device (can choose other configuration).

数控折弯机 AMD-SKZ

CNC Press Brake AMD-SKZ



产品特点

- 采用钢板焊接结构;
- 振动时消除应力, 机床具有很好的刚性和稳定性;
- 整个机架刚性好, 工作平稳、安全可靠、操作方便;
- 通过电气和液压系统的协调控制, 达到理想的折弯效果。

◇ 技术参数 Technical Parameters

规格型号 Specification	公称压力 Nominal pressure KN	工作台长度 Length of working table mm	立柱间距高 Distance up rights mm	喉口深度 Throat between depths mm	滑块行程 Ram stroke mm	电机功率 Motor power KW
WC67Y40/2200	400	2200	1700	200	100	4
WC67Y40/2500	400	2500	1900	200	100	4
WC67Y50/2500	500	2500	1900	250	100	4
WC67Y50/3200	500	3200	2500	250	100	4
WC67Y63/2500	630	2500	1900	250	120	5.5
WC67Y63/3200	630	3200	2500	250	120	5.5
WC67Y80/3200	800	3200	2500	250	120	5.5
WC67Y80/4000	800	4000	3000	250	120	5.5
WC67Y100/2500	1000	2500	1900	320	120	7.5
WC67Y100/3200	1000	3200	2500	320	120	7.5
WC67Y100/4000	1000	4000	3000	320	120	7.5
WC67Y100/5000	1000	5000	4000	320	120	7.5
WC67Y125/2500	1250	2500	1900	320	120	7.5
WC67Y125/3200	1250	3200	2500	320	120	7.5
WC67Y125/4000	1250	4000	3000	320	120	7.5
WC67Y125/5000	1250	5000	4000	320	120	7.5
WC67Y160/3200	1600	3200	2500	320	200	11
WC67Y160/4000	1600	4000	3000	320	200	11
WC67Y160/5000	1600	5000	4000	320	200	15
WC67Y160/6000	1600	6000	4800	320	200	15
WC67Y200/3200	2000	3200	2600	320	200	15
WC67Y200/4000	2000	4000	3100	320	200	15
WC67Y200/5000	2000	5000	4000	320	200	15
WC67Y200/6000	2000	6000	4800	320	200	15
WC67Y250/3200	2500	3200	2600	400	250	18.5
WC67Y250/4000	2500	4000	3200	400	250	18.5
WC67Y250/5000	2500	5000	4000	400	250	18.5
WC67Y300/4000	3000	4000	3300	400	250	22
WC67Y300/5000	3000	5000	4000	400	250	22
WC67Y300/6000	3000	6000	5800	400	250	22
WC67Y400/5000	4000	5000	4000	400	250	30
WC67Y400/6000	4000	6000	4800	400	250	30
WC67Y500/6000	5000	6000	4800	400	300	37
WC67Y600/7000	6000	6000	5600	400	300	45
WC67Y700/7000	7000	7000	5600	400	300	45

Product Features

- Uses the steel plate welding structure;
- Vibration aging eliminate stress, the machine has very good rigidity and stability;
- The whole frame rigid, stable, safe and reliable, easy to operate;
- Through the electrical and hydraulic system coordinated control, to achieve the ideal bending effect.

型材生产线

Profile Production Line



T型钢冲孔机、T型钢冲压压机、槽钢...



铁、铝、铜、不锈钢等型材管材上冲...



圆管冲孔机、圆管冲压压机...



钢管冲孔机、钢管冲压压机...



H型钢冲孔机、H型钢冲压压机...



方管、长方管、圆管、四方管、椭圆...

产品特点 Product Features

- 该数控冲孔生产线是电力，通讯，铁塔，角钢，型材，幕墙，门窗，风口型材的全自动化冲孔专用设备。作业范围：应用于各种槽钢，角钢，圆管，方管等型材加工长度孔型可根据客户要求制作。
- 设备钢性强，结构紧凑，优化排料，材料利用率高。
- 冲孔、切断等均自动进行，生产效率高。
- 电脑中文界面，操作简易，可显示工件图形。可直接在电脑上编程，输入数据，也可以实现ATUOCAD图形自动转换。
- 电脑控制生产线，实现角钢、型材上冲压任意间距的排孔，保证精度，可以实现批量加工。

技术参数

Technical Parameters

名 称	单位	参数
加工长度	m	5, 10, 12或定做
进给精度	mm	±0.1
工作电源	V	380 ± 10%
加工速度	m/min	30

Item	Unit	Parameter
Processing length	m	5, 10, 12或定做
Feeding accuracy	mm	±0.1
Power supply	V	380 ± 10%
Processing speed	m/min	30

Product Features

- This CNC punching production line is full automatic punching equipment for electricity, telecommunications, iron tower, angle bar, profiles, walls, doors and windows, outlet profiles. Operating range: angle steel, round pipe, square tube, etc profiles, processing length and hole shapes can be selected according to customers' requirements.
- Strong equipment rigidity, structure compact, optimizing nesting, high material utilization.
- Punching, cutting etc are automatic, with high production efficiency.
- Computer Chinese interface, easy operation, the workpiece graphics can be displayed. Can be programmed directly on the computer, enter data, also can achieve ATUOCAD graphics automatically converted.
- Computer-controlled production line, can punch holes in any row spacing on angle bar, profiles, ensure accuracy, batch processing can be achieved.